



7/8" BORE STAINLESS STEEL CYLINDER

SSN-14-□-□

Single Acting



Mount: Stud **Standard Stroke Lengths:** 1/2, 1, 1-1/2, 2, 3, 4
Type: Non-Rotating Rod **Spring Compressed:** 6 lbs. **Spring At Rest:** 3 lbs.
Options: MB, H, V, S, N **Bumpers are standard** For magnetic bumpers add .312

For S option add .281

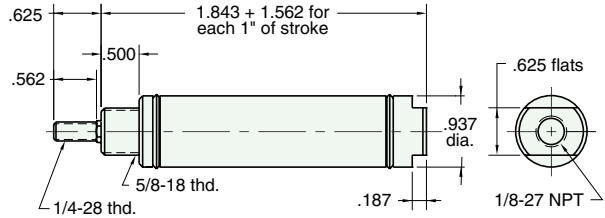

SSR-14-□-□

Single Acting



Mount: Stud **Standard Stroke Lengths:** 1/2, 1, 1-1/2, 2, 3, 4
Type: Rotating Rod **Spring Compressed:** 6 lbs. **Spring At Rest:** 3 lbs.
Options: MB, H, V, S, N **Bumpers are standard** For magnetic bumpers add .312

For S option add .281

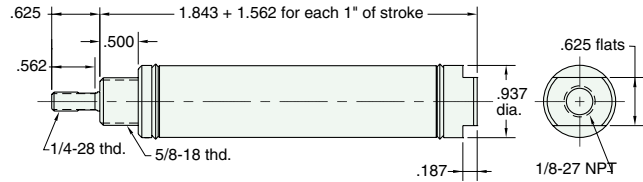

USN-14-□-□

Single Acting



Mount: Universal **Standard Stroke Lengths:** 1/2, 1, 1-1/2, 2, 3, 4 Furnished without nut(s)
See chart on page 29
Type: Non-Rotating Rod **Spring Compressed:** 6 lbs. **Spring At Rest:** 3 lbs.
Options: MB, H, V, P2, P3, P4, P5, P6, P7, P8, N **Bumpers are standard** For magnetic bumpers add .312

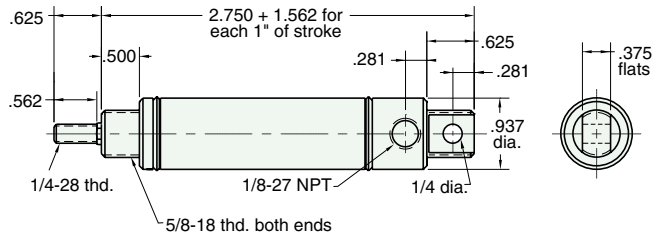

USR-14-□-□

Single Acting



Mount: Universal **Standard Stroke Lengths:** 1/2, 1, 1-1/2, 2, 3, 4 Furnished without nut(s)
See chart on page 29
Type: Rotating Rod **Spring Compressed:** 6 lbs. **Spring At Rest:** 3 lbs.
Options: MB, H, V, P2, P3, P4, P5, P6, P7, P8, N **Bumpers are standard** For magnetic bumpers add .312

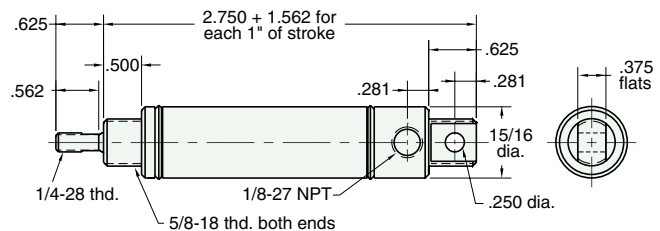

7/8" BORE STAINLESS STEEL CYLINDER



SDR-14-□-□

Double Acting



Mount: Stud **Standard Stroke Lengths:** 1/2, 1, 1-1/2, 2, 3, 4, 5, 6
Type: Rotating Rod
Options: C, F, R, MB, W, V, P6, P7, P8, S, N

Bumpers are standard
 For magnetic bumpers add .312
 For C, F, R and S option add .281

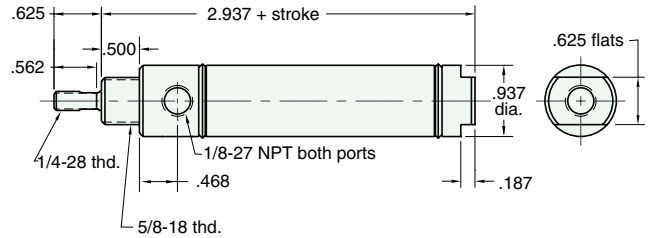

For C, F, & R options use side ported rear head

UDR-14-□-□

Double Acting



Mount: Universal **Standard Stroke Lengths:** 1/2, 1, 1-1/2, 2, 3, 4, 5, 6
Type: Rotating Rod
Options: C, F, R, MB, W, V, P2, P3, P4, P5, P6, P7, P8, N

Furnished without nut(s)
 See chart on page 29

Bumpers are standard
 For magnetic bumpers add .312

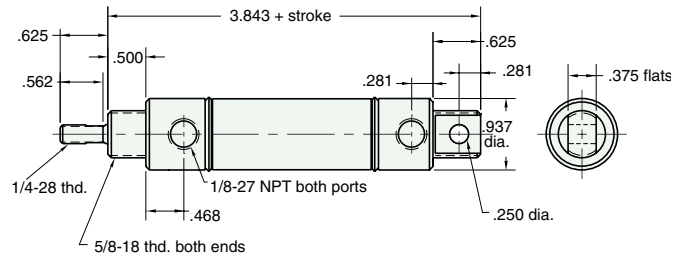

SDD-14-□-□

Double Acting



Mount: Stud **Standard Stroke Lengths:** 1, 2, 3, 4, 5, 6
Type: Double Rod
Options: C, F, MB, W, V, P6, P7, P8, N

Bumpers are standard
 For magnetic bumpers add .312

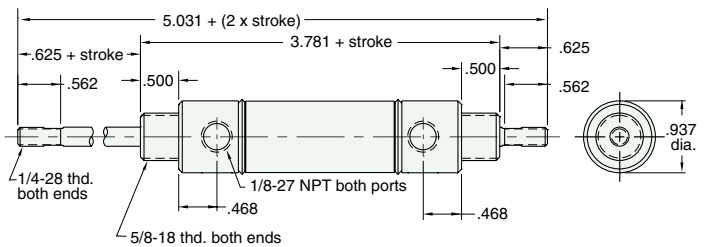

SDH-14-□-□

Double Acting



Mount: Stud **Standard Stroke Lengths:** 1, 2, 3, 4, 5, 6
Type: Hollow Rod
Options: C, F, MB, W, V, P6, P7, P8, N

Bumpers are standard
 For magnetic bumpers add .312

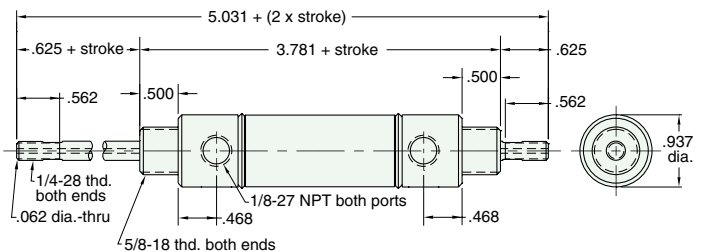



7/8" BORE STAINLESS STEEL CYLINDER

SRR-14-□-□

Reverse Acting

Mount: Stud
Type: Rotating Rod
Options: MB, H, W, V, N

Standard Stroke Lengths: 1/2, 1, 1-1/2, 2, 3, 4
Spring Compressed: 6 lbs. **Spring At Rest:** 3 lbs.

Bumpers are standard

For magnetic bumpers add .312

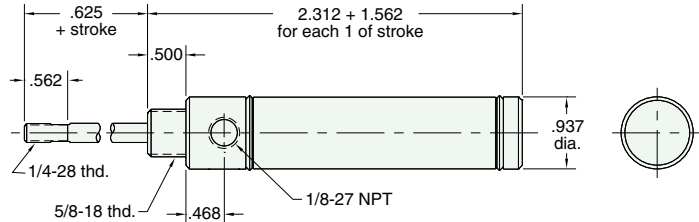
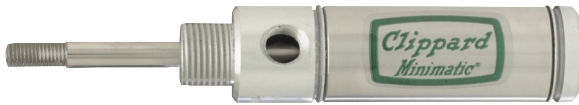

URR-14-□-□

Reverse Acting

Mount: Universal
Type: Rotating Rod
Options: MB, H, W, V, P6, P7, P8, N

Standard Stroke Lengths: 1/2, 1, 1-1/2, 2, 3, 4
Spring Compressed: 6 lbs. **Spring At Rest:** 3 lbs.

Furnished without nut(s)
See chart on page 29

Bumpers are standard

For magnetic bumpers add .312

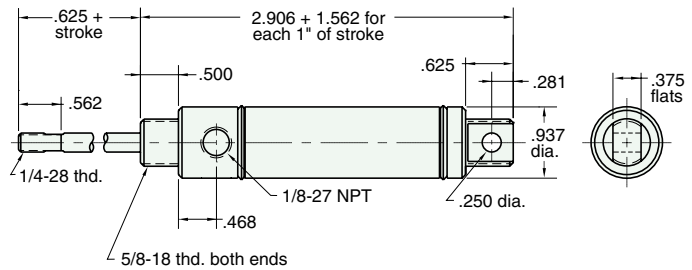

J-Series Exhaust Valve

In a typical application the exhaust valve is installed in the inlet of a spring return or double acting pneumatic cylinder. Supply air from a control valve is directed into the inlet port of the exhaust valve. The Buna-N poppet seals the exhaust port and allows air to flow from the outlet port of the valve into the cylinder.

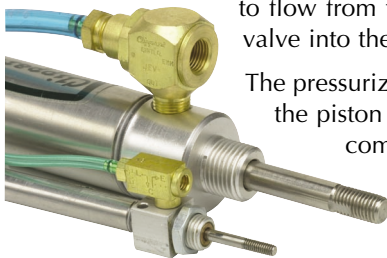

The pressurized air pushes against the piston and extends the rod, compressing the spring, until full rod extension is achieved.

When the control valve exhausts air from the exhaust valve inlet port, the Buna-N poppet shifts to seal the inlet port and open the exhaust port to the cylinder. The pressurized air is allowed to exhaust directly through the exhaust valve to atmosphere.

Normally the air must travel back through the long air line to the control valve to exhaust. By mounting the exhaust valve directly on the cylinder, the piston retracts quickly since the distance to atmosphere is very short and unrestricted.

Cylinder Extends

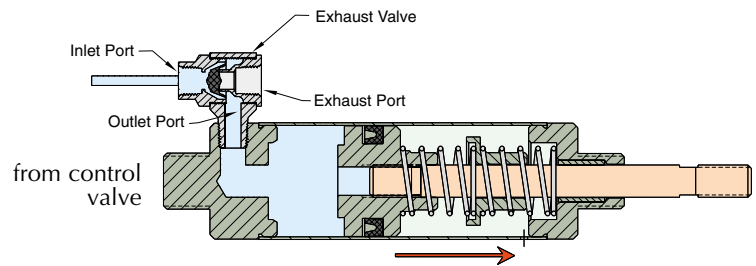

Cylinder Retracts - Fast!

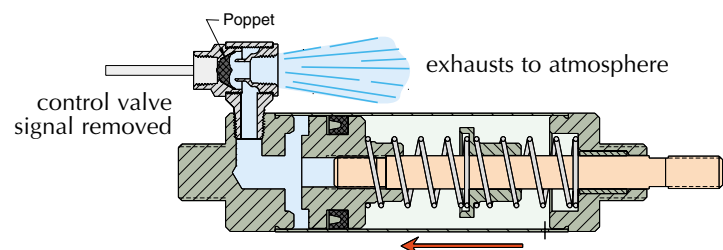



CB-1795

Clevis Bracket
Material: steel, bright zinc plated

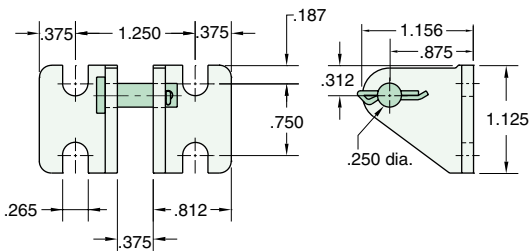

RC-1281

Rod Clevis
Material: steel, bright zinc plated

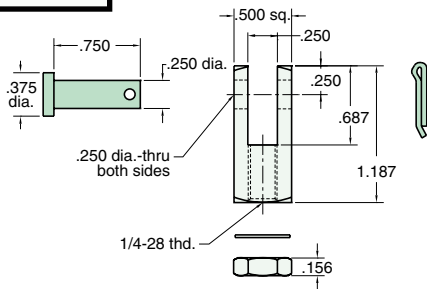

FB-1791

Foot Bracket
Material: steel, bright zinc plated

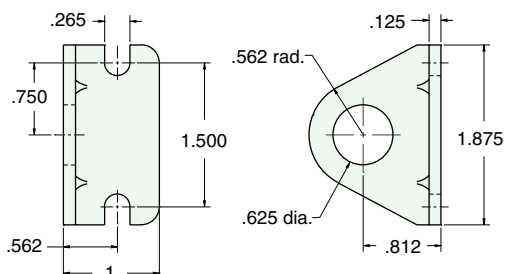

MOUNTING NUTS

Stud Nut

Part Number	Across Flats	Nut Thickness	Nut (Thread)
N10-18	15/16	3/8	5/8-18

Rod Nut

Part Number	Across Flats	Nut Thickness	Nut (Thread)
N04-28A	7/16	5/32	1/4-28
N04-28B	3/8	1/8	1/4-28

RE-1285

Rod End
Material: steel, bright zinc plated body

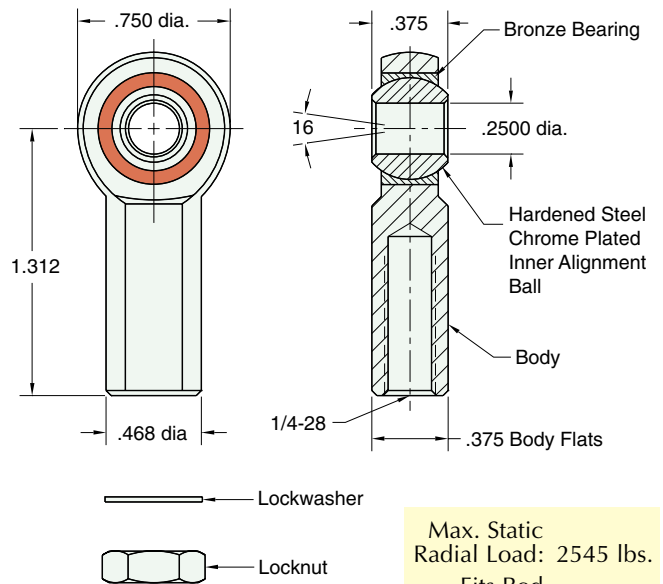

Max. Static Radial Load: 2545 lbs.
 Fits Rod Thread Size: 1/4-28



1 1/16" BORE STAINLESS STEEL CYLINDER

FSR-17-□-□

Single Acting



Mount: Front **Standard Stroke Lengths:** 1/2, 1, 1-1/2, 2, 3, 4
Type: Rotating Rod **Spring Compressed:** 7 lbs. **Spring At Rest:** 2 lbs.
Options: MB, B, H, V, S, N For magnetic bumpers add .312
For S option add .250

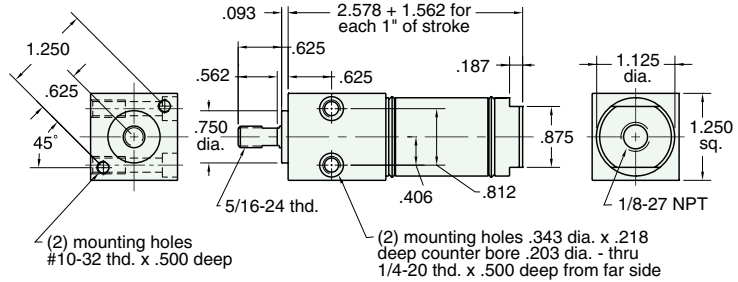

SSN-17-□-□

Single Acting



Mount: Stud **Standard Stroke Lengths:** 1/2, 1, 1-1/2, 2, 3, 4
Type: Non-Rotating Rod **Spring Compressed:** 7 lbs. **Spring At Rest:** 2 lbs.
Options: MB, B, H, V, S, N For magnetic bumpers add .312
For S option add .250

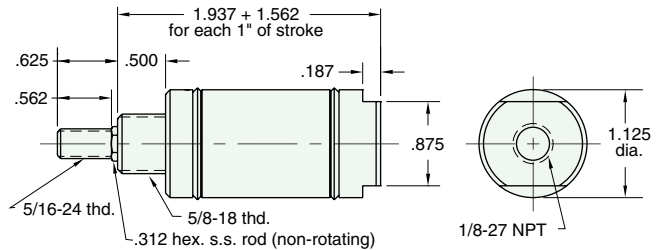

SSR-17-□-□

Single Acting



Mount: Stud **Standard Stroke Lengths:** 1/2, 1, 1-1/2, 2, 3, 4
Type: Rotating Rod **Spring Compressed:** 7 lbs. **Spring At Rest:** 2 lbs.
Options: MB, B, H, V, S, N For magnetic bumpers add .312
For S option add .250

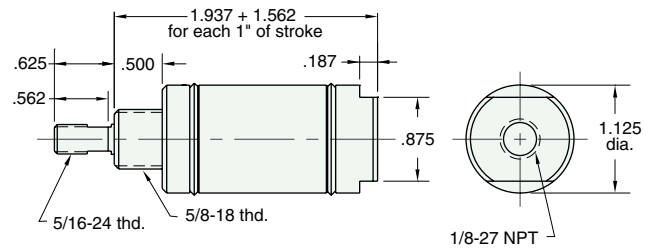

TSR-17-□-□

Single Acting



Mount: Trunnion **Standard Stroke Lengths:** 1/2, 1, 1-1/2, 2, 3, 4
Type: Rotating Rod **Spring Compressed:** 7 lbs. **Spring At Rest:** 2 lbs.
Options: MB, B, H, V, S, N For magnetic bumpers add .312
For S option add .250

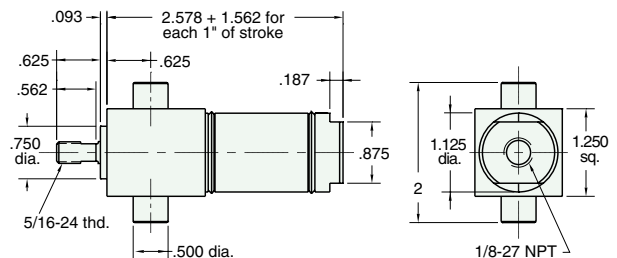

1 1/16" BORE STAINLESS STEEL CYLINDER



USN-17-□-□

Single Acting

Mount: Universal **Standard Stroke Lengths:** 1/2, 1, 1-1/2, 2, 3, 4 Furnished without nut(s) See chart on page 35
Type: Non-Rotating Rod **Spring Compressed:** 7 lbs. **Spring At Rest:** 2 lbs.
Options: MB, B, H, V, P6, N For magnetic bumpers add .312

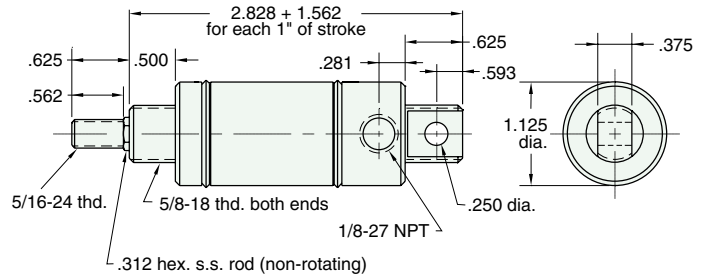

USR-17-□-□

Single Acting

Mount: Universal **Standard Stroke Lengths:** 1/2, 1, 1-1/2, 2, 3, 4 Furnished without nut(s) See chart on page 35
Type: Rotating Rod **Spring Compressed:** 7 lbs. **Spring At Rest:** 2 lbs.
Options: MB, B, H, V, P6, N For magnetic bumpers add .312

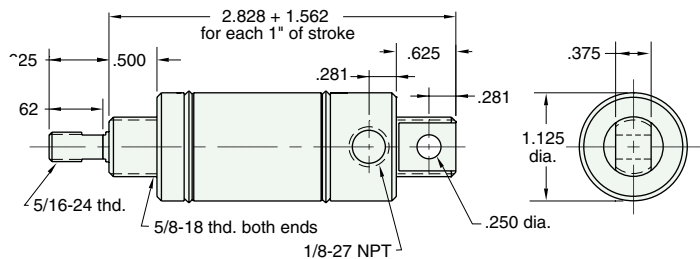

FDR-17-□-□

Double Acting

Mount: Front **Standard Stroke Lengths:** 1/2, 1, 1-1/2, 2, 3, 4, 5, 6 Furnished without nut(s) See chart on page 35
Type: Rotating Rod **Spring Compressed:** 7 lbs. **Spring At Rest:** 2 lbs.
Options: MB, B, W, V, P6, P7, P8, S, N For magnetic bumpers add .312 For S option add .250

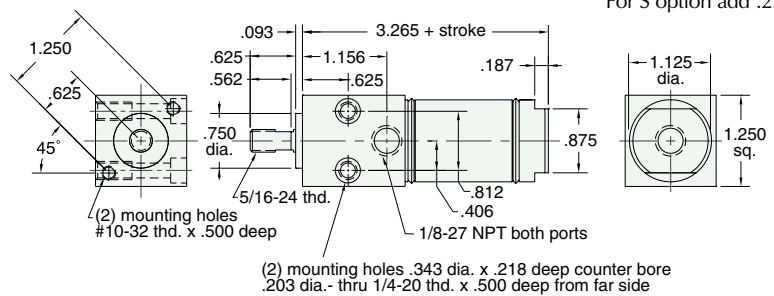

SDR-17-□-□

Double Acting

Mount: Stud **Standard Stroke Lengths:** 1/2, 1, 1-1/2, 2, 3, 4, 5, 6 Furnished without nut(s) See chart on page 35
Type: Rotating Rod **Spring Compressed:** 7 lbs. **Spring At Rest:** 2 lbs.
Options: C, F, R, MB, B, W, V, P6, P7, P8, S, N For magnetic bumpers add .312 For C, F, R or S option add .250

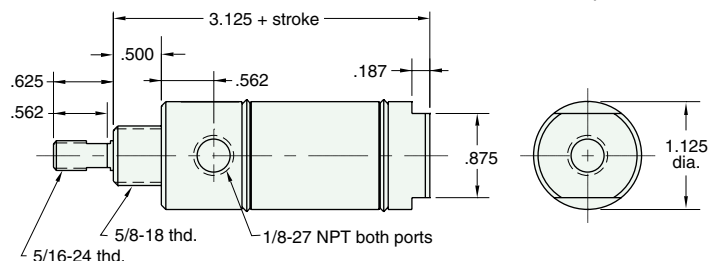

For C, F, & R options use side ported rear head



1 1/16" BORE STAINLESS STEEL CYLINDER

TDR-17-□-□

Double Acting

Mount: Trunnion **Standard Stroke Lengths:** 1/2, 1, 1-1/2, 2, 3, 4, 5, 6
Type: Rotating Rod
Options: MB, B, W, V, S, N

For magnetic bumpers add .312

For S option add .250

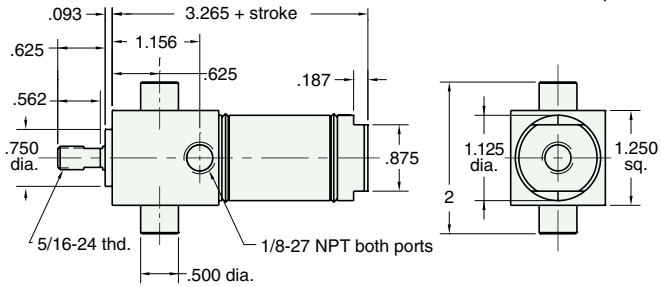

UDR-17-□-□

Double Acting

Mount: Universal **Standard Stroke Lengths:** 1/2, 1, 1-1/2, 2, 3, 4, 5, 6, 8, 10, 12
Type: Rotating Rod
Options: C, F, R, MB, B, W, V, P2, P3, P4, P5, P6, P7, P8, N

Furnished without nut(s)
See chart on page 35

For magnetic bumpers add .312

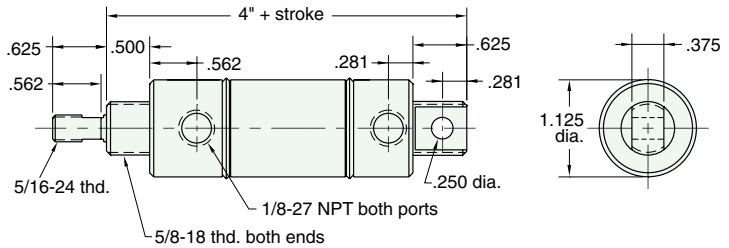

SDD-17-□-□

Double Acting

Mount: Stud **Standard Stroke Lengths:** 1, 2, 3, 4, 5, 6
Type: Double Rod
Options: C, F, R, MB, B, W, V, P6, P7, P8, N

For magnetic bumpers add .312

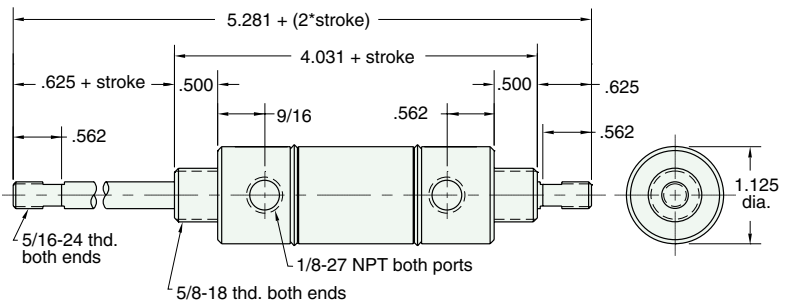

SDH-17-□-□

Double Acting

Mount: Stud **Standard Stroke Lengths:** 1, 2, 3, 4, 5, 6
Type: Hollow Rod
Options: C, F, MB, B, W, V, P6, P7, P8, N

For magnetic bumpers add .312

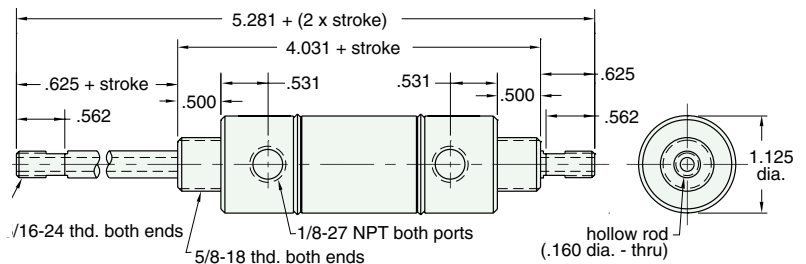

1 1/16" BORE STAINLESS STEEL CYLINDER



SRR-17-□-□

Reverse Acting

Mount: Stud **Standard Stroke Lengths:** 1/2, 1, 1-1/2, 2, 3, 4
Type: Rotating Rod **Spring Compressed:** 7 lbs. **Spring At Rest:** 2 lbs.
Options: MB, B, H, W, V, N For magnetic bumpers add .312

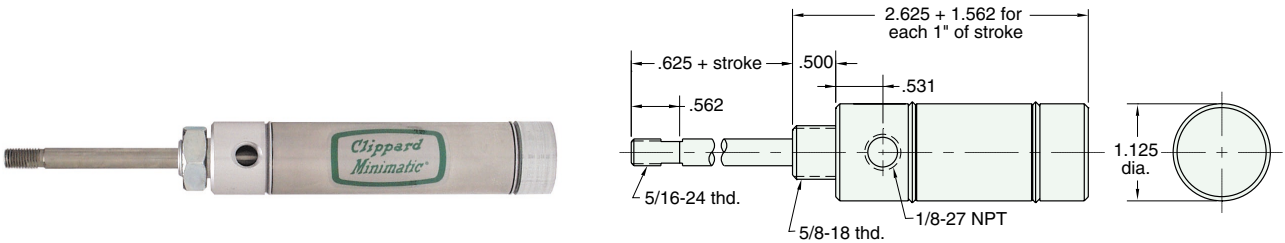

URR-17-□-□

Reverse Acting

Mount: Universal **Standard Stroke Lengths:** 1/2, 1, 1-1/2, 2, 3, 4 Furnished without nut(s)
See chart on page 35
Type: Rotating Rod **Spring Compressed:** 7 lbs. **Spring At Rest:** 2 lbs.
Options: MB, B, H, W, V, P6, N For magnetic bumpers add .312

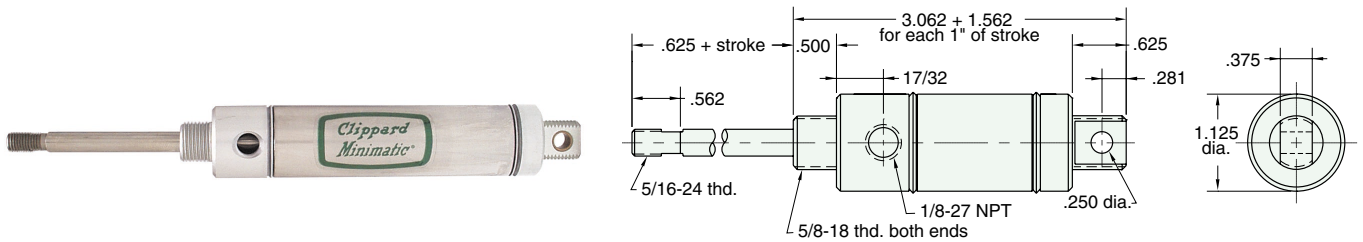

SFD-17-□-□

Spring Bias

Mount: Stud **Standard Stroke Lengths:** 1/2, 1, 1-1/2, 2, 3, 4
Type: Double Rod **Spring Compressed:** 7 lbs. **Spring At Rest:** 2 lbs.
Options: MB, B, H, W, V, P6, P7, P8, N For magnetic bumpers add .312

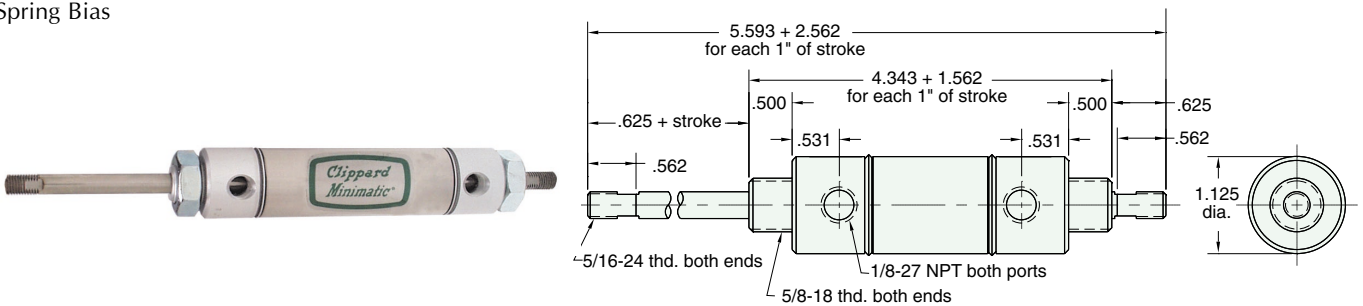

SBR-17-□-□

Double Acting Rear Spring Bias

Mount: Stud **Standard Stroke Lengths:** 1/2, 1, 1-1/2, 2, 3, 4
Type: Rotating Rod **Spring Compressed:** 7 lbs. **Spring At Rest:** 2 lbs.
Options: MB, B, H, W, V, P6, P7, P8, S, N For magnetic bumpers add .312
 For S option add .250

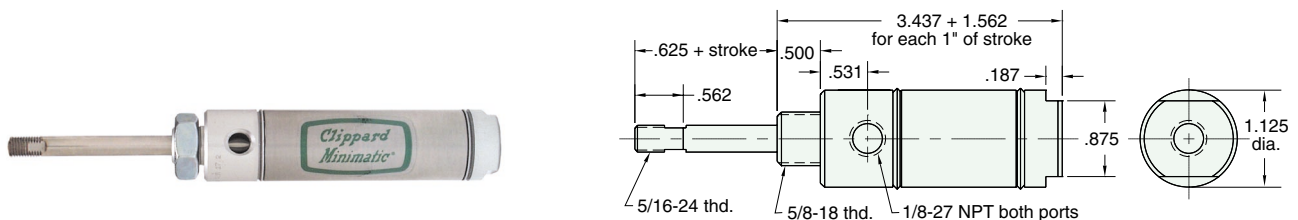



1 1/16" BORE STAINLESS STEEL CYLINDER

SFR-17-□-□

Double Acting, Spring Bias



Mount: Stud **Standard Stroke Lengths:** 1/2, 1, 1-1/2, 2, 3, 4
Type: Rotating Rod **Spring Compressed:** 7 lbs. **Spring At Rest:** 2 lbs.
Options: MB, B, H, W, V, P6, P7, P8, S, N For magnetic bumpers add .312
For S option add .250

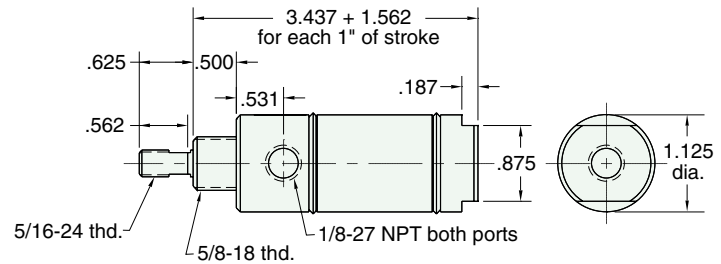

UBR-17-□-□

Double Acting, Rear Spring Bias



Mount: Universal **Standard Stroke Lengths:** 1/2, 1, 1-1/2, 2, 3, 4
Type: Rotating Rod **Spring Compressed:** 7 lbs. **Spring At Rest:** 2 lbs.
Options: MB, B, H, W, V, P2, P3, P4, P5, P6, P7, P8, N For magnetic bumpers add .312

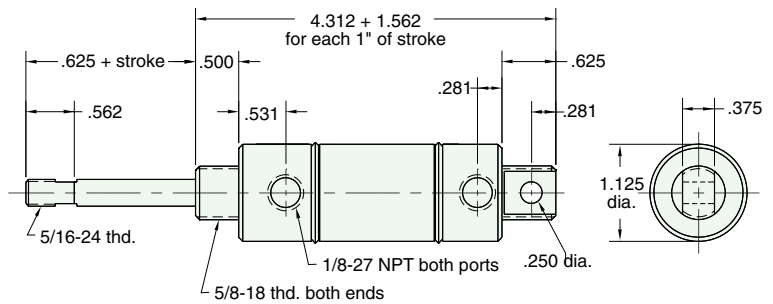

UFR-17-□-□

Double Acting Front Spring Bias



Mount: Universal **Standard Stroke Lengths:** 1/2, 1, 1-1/2, 2, 3, 4
Type: Rotating Rod **Spring Compressed:** 7 lbs. **Spring At Rest:** 2 lbs.
Options: MB, B, H, W, V, P2, P3, P4, P5, P6, P7, P8, N For magnetic bumpers add .312

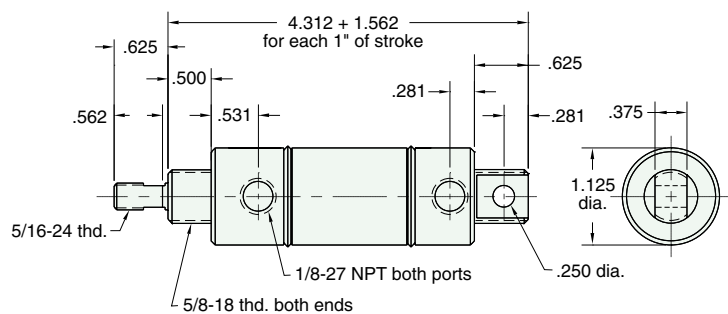



MOUNTING NUTS

Stud Nut

Part Number	Across Flats	Nut Thickness	Nut (Thread)
N10-18	15/16	3/8	5/8-18

Rod Nut

Part Number	Across Flats	Nut Thickness	Nut (Thread)
N05-24	1/2	3/16	5/16-24

CB-1795

Clevis Bracket
Material: steel, bright zinc plated

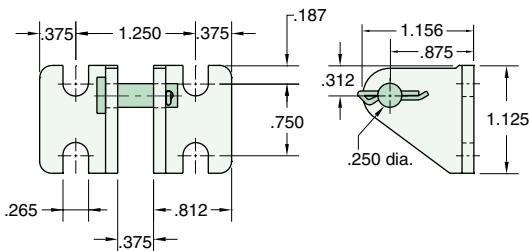

RC-1781

Rod Clevis
Material: steel, bright zinc plated

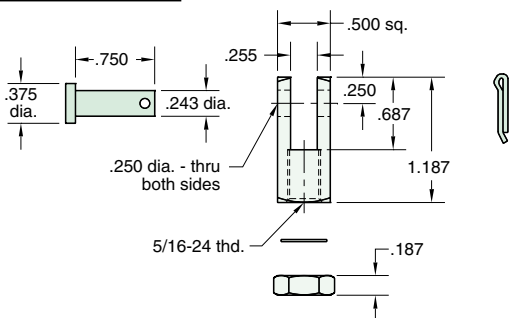

RE-1785

Rod End
Material: steel, bright zinc plated body

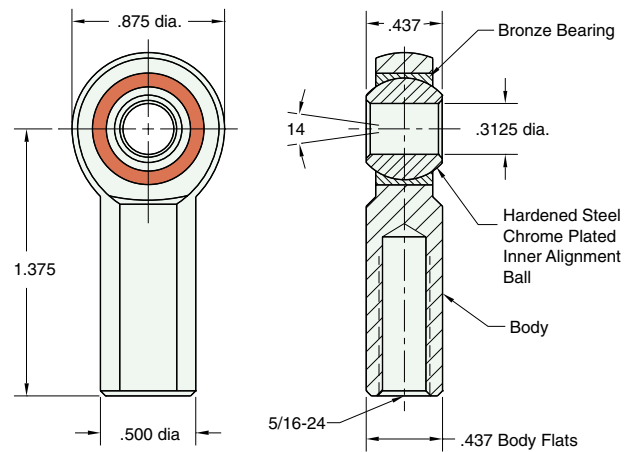

Lockwasher

Locknut

Max. Static Radial Load: 3200 lbs.
Fits Rod Thread Size: 5/16-24

FB-1791

Foot Bracket
Material: steel, bright zinc plated

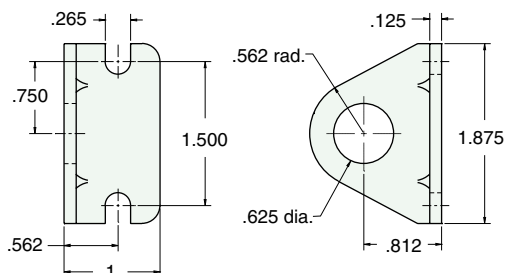



1 1/4" BORE STAINLESS STEEL CYLINDER

Note: The 1 1/4" bore is also available with a 7/16-20 threaded rod. Order -LR option.

SSN-20-□-□

Single Acting

Mount: Stud **Standard Stroke Lengths:** 1/2, 1, 1-1/2, 2, 3, 4
Type: Non-Rotating Rod **Spring Compressed:** 10 lbs. **Spring At Rest:** 4.5 lbs.
Options: MB, B, H, V, S, N

For S option add .312

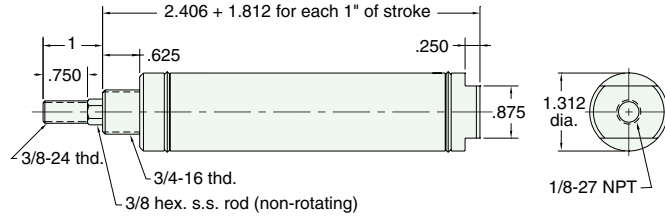

SSR-20-□-□

Single Acting

Mount: Stud **Standard Stroke Lengths:** 1/2, 1, 1-1/2, 2, 3, 4
Type: Rotating Rod **Spring Compressed:** 10 lbs. **Spring At Rest:** 4.5 lbs.
Options: MB, B, H, V, S, N

For S option add .312

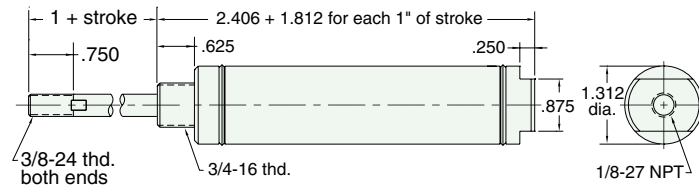

USN-20-□-□

Single Acting

Mount: Universal **Standard Stroke Lengths:** 1/2, 1, 1-1/2, 2, 3, 4 Furnished without nut(s)
See chart on page 39
Type: Non-Rotating Rod **Spring Compressed:** 10 lbs. **Spring At Rest:** 4.5 lbs.
Options: MB, B, H, V, P2, P3, P4, P5, P6, P7, P8, N For magnetic bumpers add .312

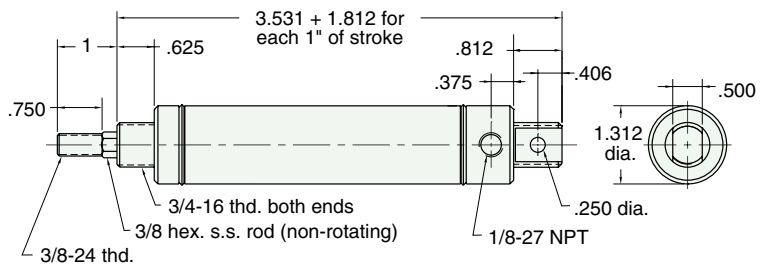

USR-20-□-□

Single Acting

Mount: Universal **Standard Stroke Lengths:** 1/2, 1, 1-1/2, 2, 3, 4 Furnished without nut(s)
See chart on page 39
Type: Rotating Rod **Spring Compressed:** 10 lbs. **Spring At Rest:** 4.5 lbs.
Options: MB, B, H, V, P2, P3, P4, P5, P6, P7, P8, N For magnetic bumpers add .312

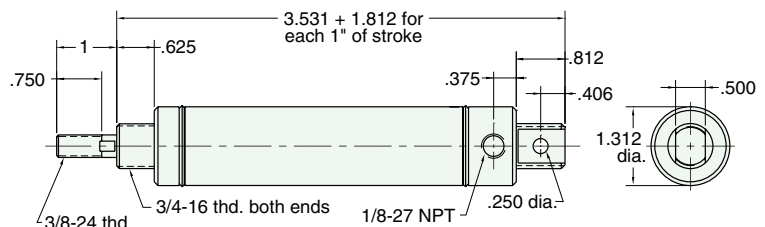

1 1/4" BORE STAINLESS STEEL CYLINDER



Note: The 1 1/4" bore is also available with a 7/16-20 threaded rod. Order -LR option.

SDR-20-□-□

Double Acting

Mount: Stud **Standard Stroke Lengths:** 1/2, 1, 1-1/2, 2, 3, 4, 5, 6
Type: Rotating Rod
Options: C, F, R, MB, B, W, V, P6, P7, P8, S, N For magnetic bumpers add .312
For C, F, R and S option add .312

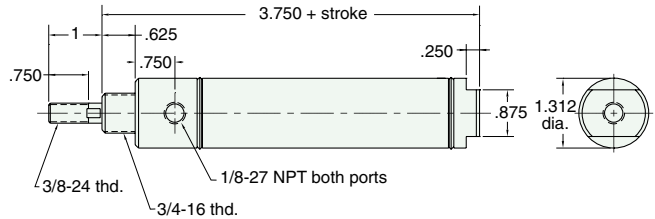

For C, F, & R options use side ported rear head

UDR-20-□-□

Double Acting

Mount: Universal **Standard Stroke Lengths:** 1/2, 1, 1-1/2, 2, 3, 4, 6, 8, 10, 12 Furnished without nut(s)
See chart on page 39
Type: Rotating Rod
Options: C, F, R, MB, B, W, V, P2, P3, P4, P5, P6, P7, P8, N For magnetic bumpers add .312

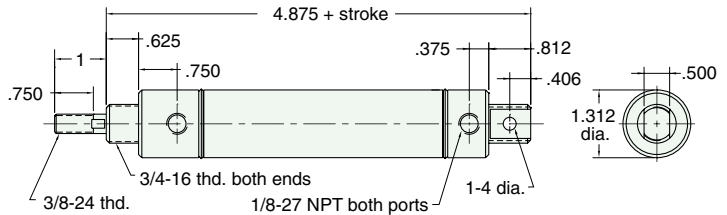

SDD-20-□-□

Double Acting

Mount: Stud **Standard Stroke Lengths:** 1, 2, 3, 4, 5, 6
Type: Double Rod
Options: C, F, MB, B, W, V, P6, P7, P8, N For magnetic bumpers add .312

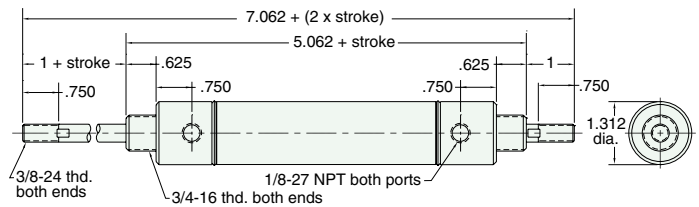

SRR-20-□-□

Reverse Acting

Mount: Stud **Standard Stroke Lengths:** 1/2, 1, 1-1/2, 2, 3, 4
Type: Rotating Rod **Spring Compressed:** 10 lbs. **Spring At Rest:** 4.5 lbs.
Options: MB, B, H, W, V, N For magnetic bumpers add .312

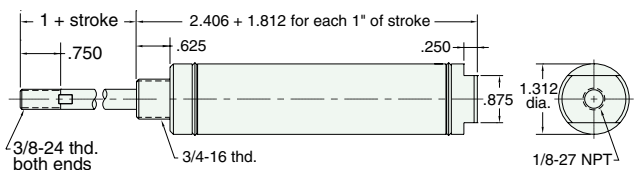



1 1/4" BORE STAINLESS STEEL CYLINDER

Note: The 1 1/4" bore is also available with a 7/16-20 threaded rod. Order -LR option.

URR-20-□-□

Reverse Acting

Mount: Universal **Standard Stroke Lengths:** 1/2, 1, 1-1/2, 2, 3, 4 Furnished without nut(s) See chart on page 39
Type: Rotating Rod **Spring Compressed:** 10 lbs. **Spring At Rest:** 4.5 lbs.
Options: MB, B, H, W, V, P6, N

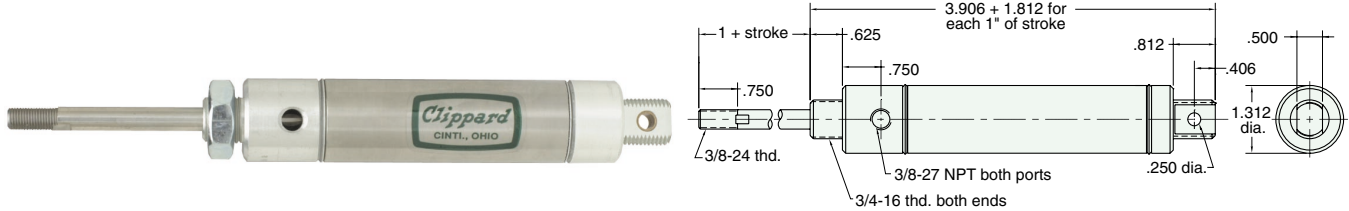

APPLICATION STORY

ap-pli-ca-tion \ap-lə-ˈkâ-shən 1 : the act of applying 2 : assiduous attention 3 : REQUEST; also : a form used in making a request 4 : something placed or spread on a surface 5 : capacity for use

Clippard Applications Have Gone to the Birds

Pneumatic automation plays a role on the roof tops of Clippard. Over time, pigeons become unruffled by the presence of a motionless plastic owl. By automating several owls throughout the area to pop up out of 8 inch PVC pipes, the pigeon problem has flown away.

While this application only requires a single acting cylinder, they tend to be longer than double acting cylinders of the same stroke. To fit the cylinder inside of the owl and have enough stroke to raise it fully, these wise old birds used double acting cylinders with a little circuitry to make them act like single acting cylinders.

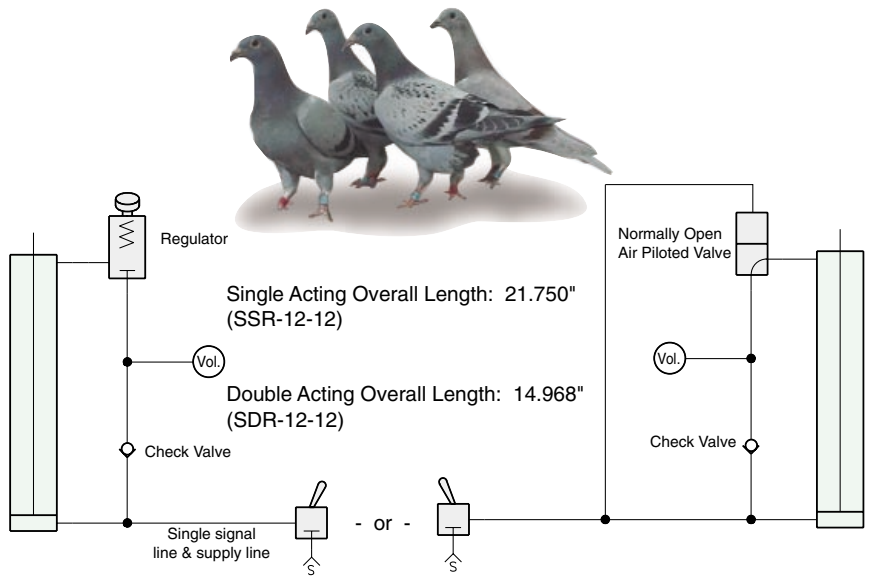

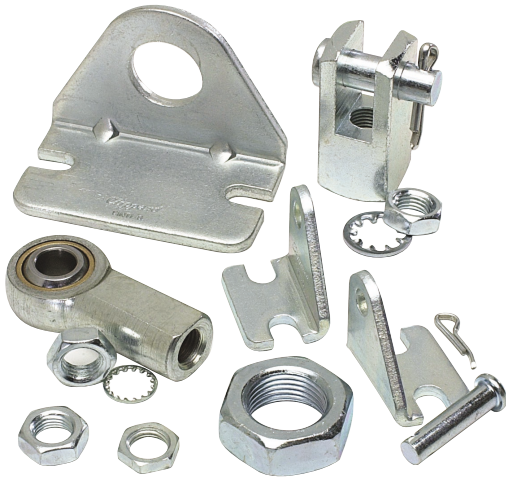

MOUNTING NUTS

Stud Nut

Part Number	Across Flats	Nut Thickness	Nut (Thread)
N12-16	1 3/32	27/64	3/4-16

Rod Nut

Part Number	Across Flats	Nut Thickness	Nut (Thread)
N06-24A	9/16	7/32	3/8-24
N06-24B	1/2	1/8	3/8-24

CB-2095

Clevis Bracket
Material: steel, bright zinc plated

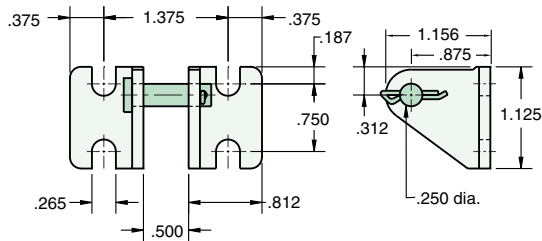

RE-2085

Rod End
Material: steel, bright zinc plated body

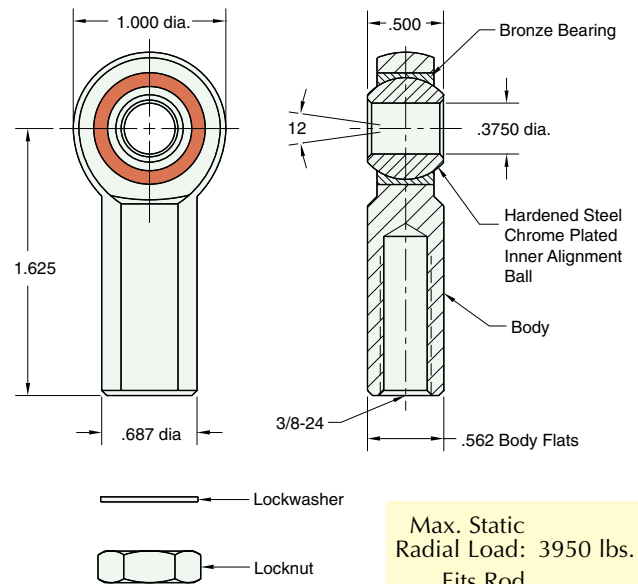

Max. Static Radial Load: 3950 lbs.
Fits Rod Thread Size: 3/8-24

RC-2081

Rod Clevis
Material: steel, bright zinc plated

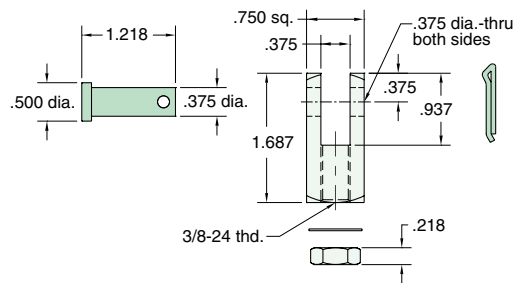

FB-2491

Foot Bracket
Material: steel, bright zinc plated

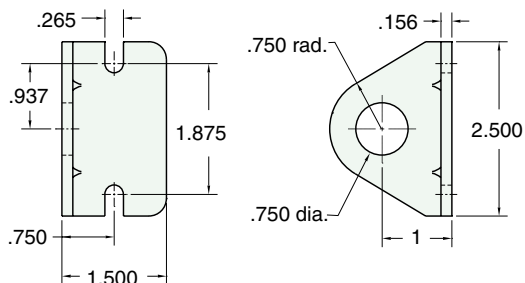



1 1/2" BORE STAINLESS STEEL CYLINDER

CSN-24-□-□

Single Acting

Mount: Clevis **Standard Stroke Lengths:** 1/2, 1, 1-1/2, 2, 3, 4 Furnished without nut(s) See chart on page 47
Type: Non-Rotating Rod **Spring Compressed:** 10 lbs. **Spring At Rest:** 4 1/2 lbs.
Options: MB, B, H, V, P6, N For magnetic bumpers add .312

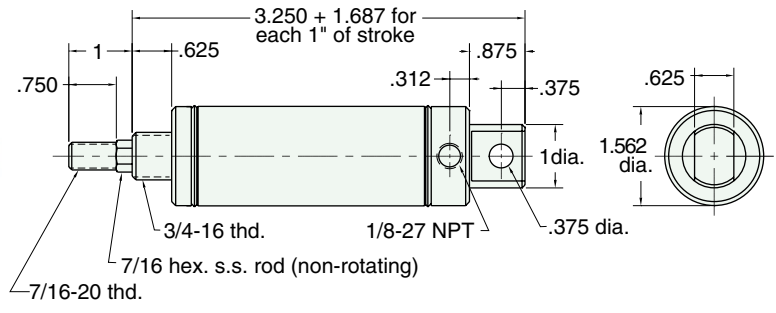

CSR-24-□-□

Single Acting

Mount: Clevis **Standard Stroke Lengths:** 1/2, 1, 1-1/2, 2, 3, 4 Furnished without nut(s) See chart on page 47
Type: Rotating Rod **Spring Compressed:** 10 lbs. **Spring At Rest:** 4 1/2 lbs.
Options: MB, B, H, V, P6, N For magnetic bumpers add .312

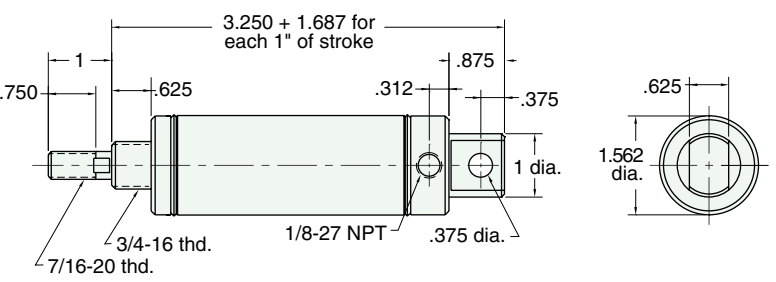

ESN-24-□-□

Single Acting

Mount: End **Standard Stroke Lengths:** 1/2, 1, 1-1/2, 2, 3, 4 Furnished without nut(s) See chart on page 47
Type: Non-Rotating Rod **Spring Compressed:** 10 lbs. **Spring At Rest:** 4 1/2 lbs.
Options: MB, B, H, V, N For magnetic bumpers add .312

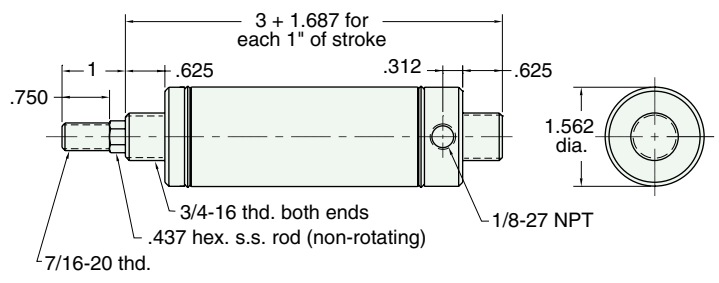

ESR-24-□-□

Single Acting

Mount: End **Standard Stroke Lengths:** 1/2, 1, 1-1/2, 2, 3, 4 Furnished without nut(s) See chart on page 47
Type: Rotating Rod **Spring Compressed:** 10 lbs. **Spring At Rest:** 4 1/2 lbs.
Options: MB, B, H, V, N For magnetic bumpers add .312

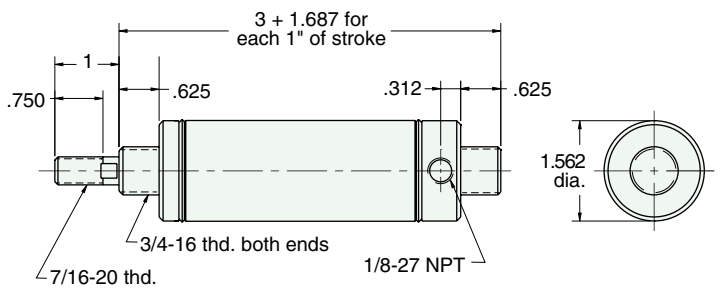

1 1/2" BORE STAINLESS STEEL CYLINDER



FSR-24-□-□

Single Acting

Mount: Front **Standard Stroke Lengths:** 1/2, 1, 1-1/2, 2, 3, 4
Type: Rotating Rod **Spring Compressed:** 10 lbs. **Spring At Rest:** 4 1/2 lbs.
Options: MB, B, H, V, S, N For magnetic bumpers add .312

For S option add .187

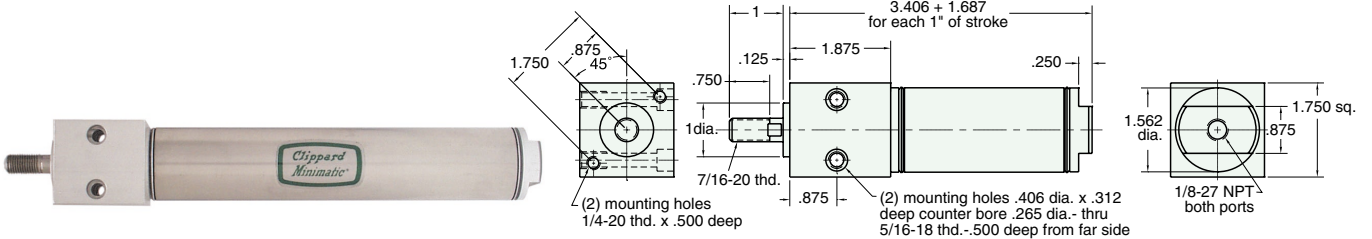

SSN-24-□-□

Single Acting

Mount: Stud **Standard Stroke Lengths:** 1/2, 1, 1-1/2, 2, 3, 4
Type: Non-Rotating Rod **Spring Compressed:** 10 lbs. **Spring At Rest:** 4 1/2 lbs.
Options: MB, B, H, V, S, N For magnetic bumpers add .312

For S option add .187

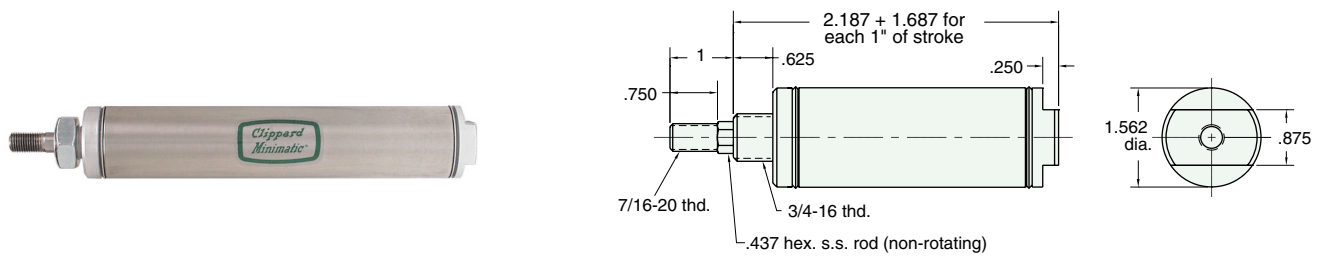

SSR-24-□-□

Single Acting

Mount: Stud **Standard Stroke Lengths:** 1/2, 1, 1-1/2, 2, 3, 4
Type: Rotating Rod **Spring Compressed:** 10 lbs. **Spring At Rest:** 4 1/2 lbs.
Options: MB, B, H, V, S, N For magnetic bumpers add .312

For S option add .187

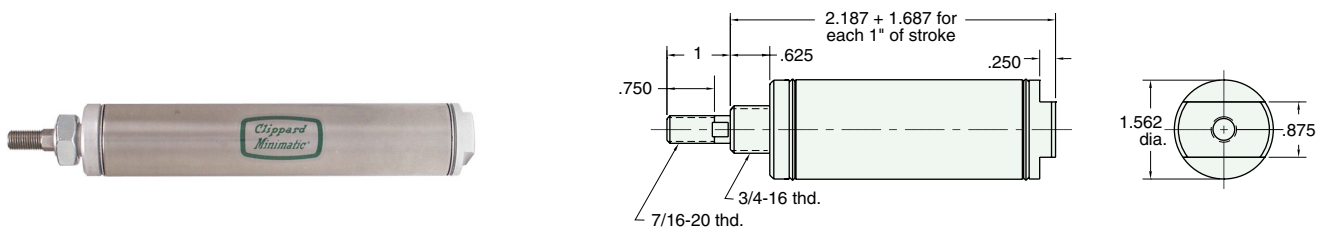

TSR-24-□-□

Single Acting

Mount: Trunnion **Standard Stroke Lengths:** 1/2, 1, 1-1/2, 2, 3, 4
Type: Rotating Rod **Spring Compressed:** 10 lbs. **Spring At Rest:** 4 1/2 lbs.
Options: MB, B, H, V, S, N For magnetic bumpers add .312

For S option add .187

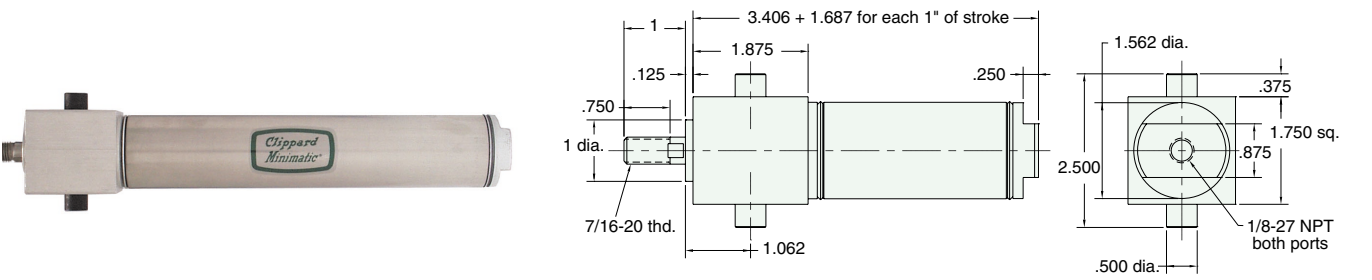



1 1/2" BORE STAINLESS STEEL CYLINDER

CDR-24-□-□

Double Acting

Mount: Clevis **Standard Stroke Lengths:** 1/2, 1, 1-1/2, 2, 3, 4 Furnished without nut(s)
See chart on page 47
Type: Rotating Rod 6, 8, 10, 12
Options: C, F, R, MB, B, W, V, P2, P3, P4, P5, P6, P7, P8, N For magnetic bumpers add .312

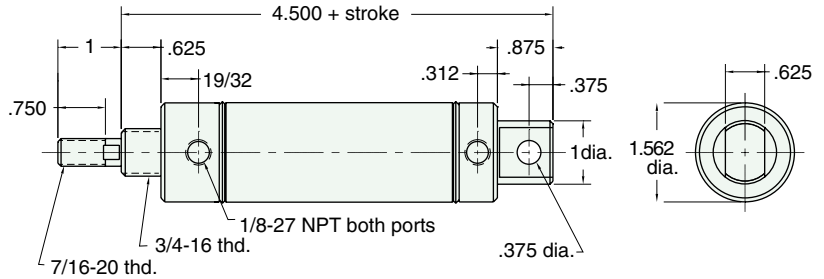

EDR-24-□-□

Double Acting

Mount: End **Standard Stroke Lengths:** 1/2, 1, 1-1/2, 2, 3, 4, 6, 8, 10, 12
Type: Rotating Rod
Options: C, F, R, MB, B, W, V, P6, P7, P8, N For magnetic bumpers add .312

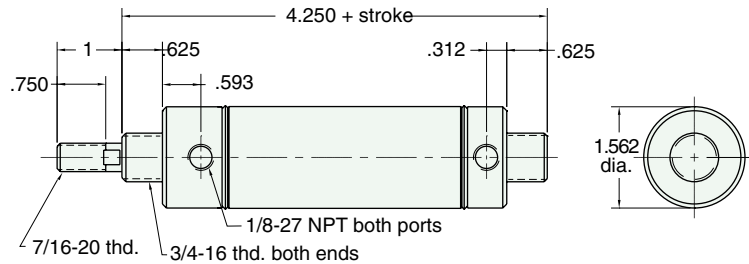

FDR-24-□-□

Double Acting

Mount: Front **Standard Stroke Lengths:** 1/2, 1, 1-1/2, 2, 3, 4, 5, 6
Type: Rotating Rod
Options: MB, B, W, V, P6, P7, P8, S, N For magnetic bumpers add .312
For S option add .187

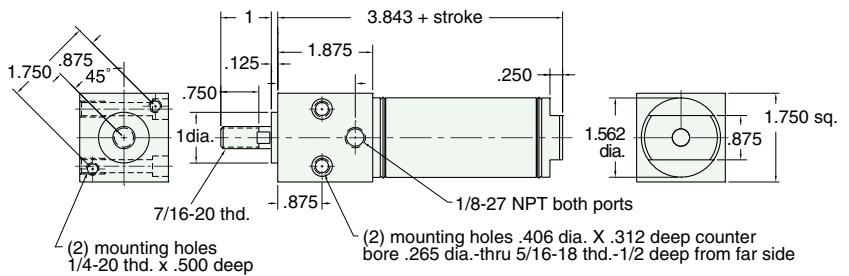

SDR-24-□-□

Double Acting

Mount: Stud **Standard Stroke Lengths:** 1/2, 1, 1-1/2, 2, 3, 4, 6, 8, 10, 12
Type: Rotating Rod
Options: C, F, R, MB, B, W, V, P6, P7, P8, S, N For magnetic bumpers add .312
For C, F, R and S option add .187

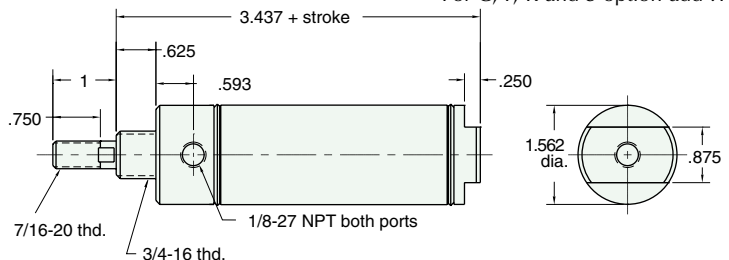

For C, F, & R options use side ported rear head

1 1/2" BORE STAINLESS STEEL CYLINDER



TDR-24-□-□

Double Acting

Mount: Trunnion **Standard Stroke Lengths:** 1/2, 1, 1-1/2, 2, 3, 4, 5, 6
Type: Rotating Rod
Options: MB, B, W, V, S, N

For magnetic bumpers add .312

For S option add .187

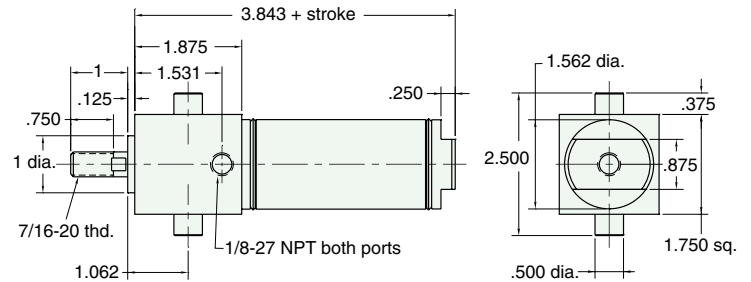

SDD-24-□-□

Double Acting

Mount: Stud **Standard Stroke Lengths:** 1, 2, 3, 4, 5, 6, 8, 10, 12
Type: Double Rod
Options: C, F, MB, B, W, V, P6, P7, P8, N

For magnetic bumpers add .312

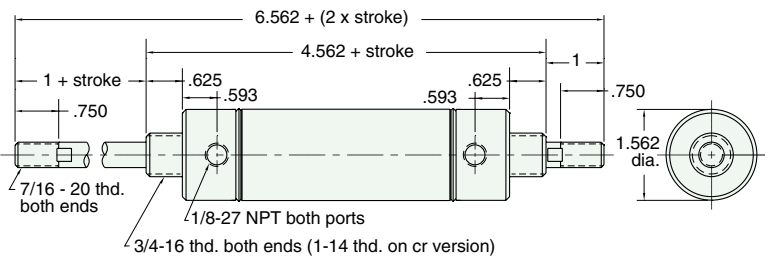

CRR-24-□-□

Reverse Acting

Mount: Clevis **Standard Stroke Lengths:** 1/2, 1, 1-1/2, 2, 3, 4
Type: Rotating Rod **Spring Compressed:** 10 lbs. **Spring At Rest:** 4 1/2 lbs.
Options: MB, B, H, W, V, P6, P7, P8, N

Furnished without nut(s)
See chart on page 47

For magnetic bumpers add .312

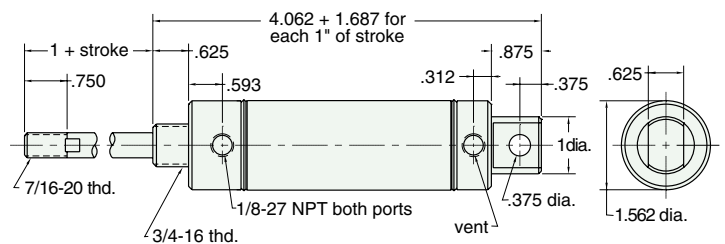

ERR-24-□-□

Reverse Acting

Mount: End **Standard Stroke Lengths:** 1/2, 1, 1-1/2, 2, 3, 4
Type: Rotating Rod **Spring Compressed:** 10 lbs. **Spring At Rest:** 4 1/2 lbs.
Options: MB, B, H, W, V, N

For magnetic bumpers add .312

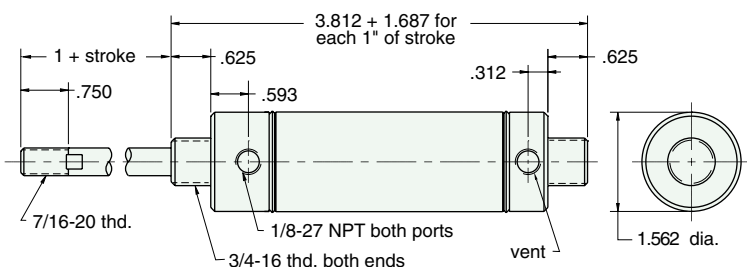



1 1/2" BORE STAINLESS STEEL CYLINDER

FRR-24-□-□

Reverse Acting

Mount: Front **Standard Stroke Lengths:** 1/2, 1, 1-1/2, 2, 3, 4 Furnished without nut(s) See chart on page 47
Type: Rotating Rod **Spring Compressed:** 10 lbs. **Spring At Rest:** 4 1/2 lbs.
Options: MB, B, H, W, V, N For magnetic bumpers add .312

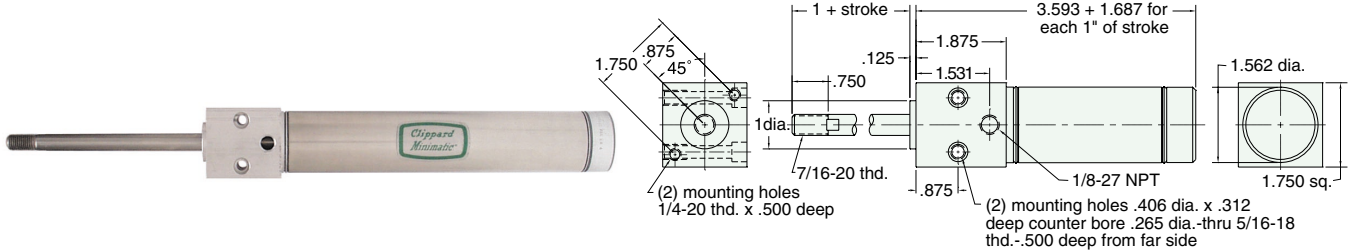

SRR-24-□-□

Reverse Acting

Mount: Stud **Standard Stroke Lengths:** 1/2, 1, 1-1/2, 2, 3, 4
Type: Rotating Rod **Spring Compressed:** 10 lbs. **Spring At Rest:** 4 1/2 lbs.
Options: MB, B, H, W, V, N For magnetic bumpers add .312

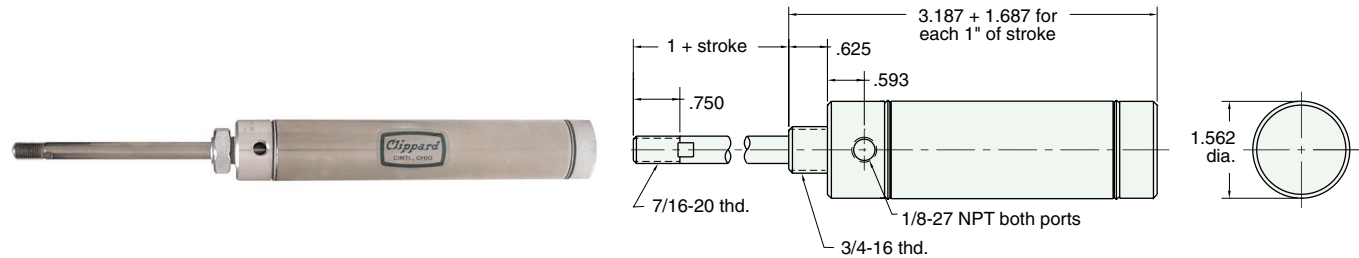

CBR-24-□-□

Double Acting, Spring Bias

Mount: Clevis **Standard Stroke Lengths:** 1/2, 1, 1-1/2, 2, 3, 4
Type: Rotating Rod **Spring Compressed:** 10 lbs. **Spring At Rest:** 4 1/2 lbs.
Options: MB, B, H, W, V, P2, P3, P4, P5, P6, P7, P8, N For magnetic bumpers add .312

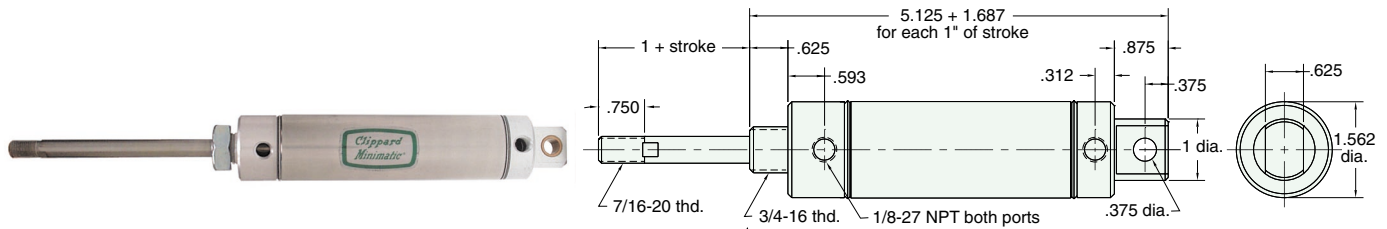

CFR-24-□-□

Double Acting, Front Spring Bias

Mount: Clevis **Standard Stroke Lengths:** 1/2, 1, 1-1/2, 2, 3, 4
Type: Rotating Rod **Spring Compressed:** 10 lbs. **Spring At Rest:** 4 1/2 lbs.
Options: MB, B, H, W, V, P2, P3, P4, P5, P6, P7, P8, N For magnetic bumpers add .312

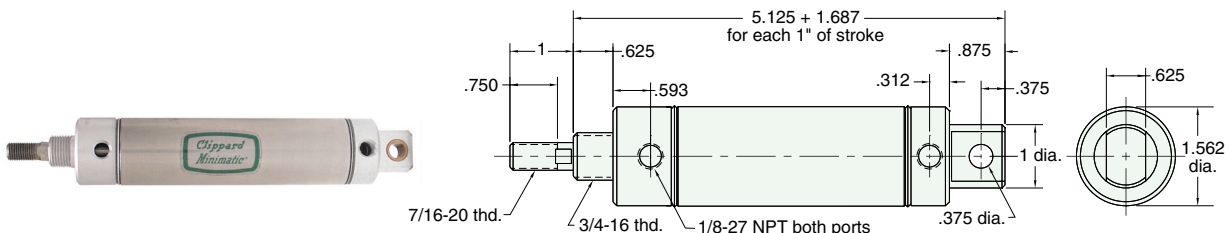

1 1/2" BORE STAINLESS STEEL CYLINDER



EBR-24-□-□

Double Acting, Rear Spring Bias

Mount: End **Standard Stroke Lengths:** 1/2, 1, 1-1/2, 2, 3, 4
Type: Rotating Rod **Spring Compressed:** 10 lbs. **Spring At Rest:** 4 1/2 lbs.
Options: MB, B, H, W, V, P6, P7, P8, N For magnetic bumpers add .312

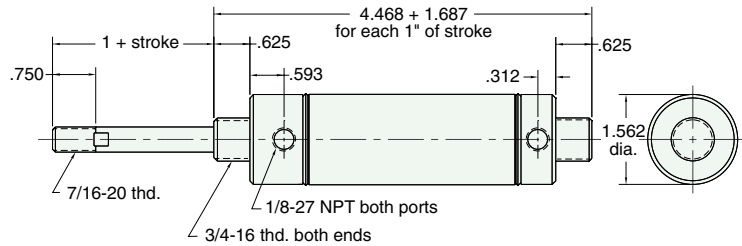

EFR-24-□-□

Double Acting, Front Spring Bias

Mount: End **Standard Stroke Lengths:** 1/2, 1, 1-1/2, 2, 3, 4
Type: Rotating Rod **Spring Compressed:** 10 lbs. **Spring At Rest:** 4 1/2 lbs.
Options: MB, B, H, W, V, P6, P7, P8, N For magnetic bumpers add .312

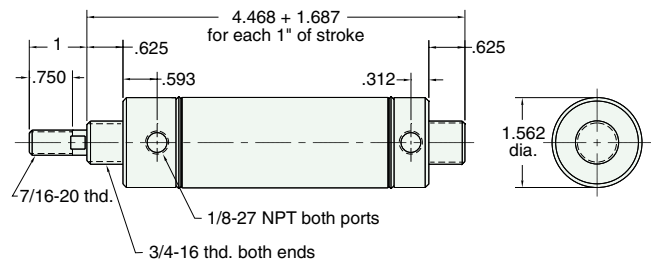

SFD-24-□-□

Double Acting, Front Spring Bias

Mount: Stud **Standard Stroke Lengths:** 1/2, 1, 1-1/2, 2, 3, 4
Type: Double Rod **Spring Compressed:** 10 lbs. **Spring At Rest:** 4 1/2 lbs.
Options: MB, B, H, W, V, P6, P7, P8, N For magnetic bumpers add .312

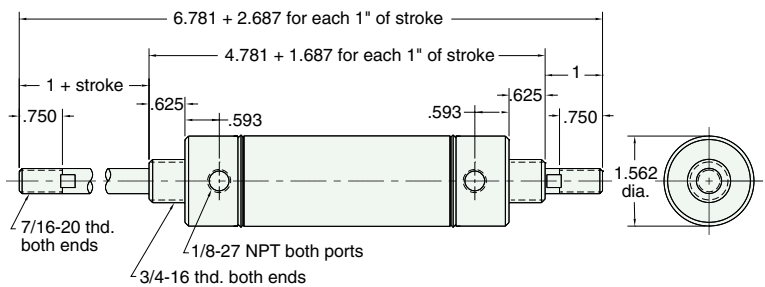

SBR-24-□-□

Double Acting, Rear Spring Bias

Mount: Stud **Standard Stroke Lengths:** 1/2, 1, 1-1/2, 2, 3, 4
Type: Rotating Rod **Spring Compressed:** 10 lbs. **Spring At Rest:** 4 1/2 lbs.
Options: MB, B, H, W, V, P6, P7, P8, S, N For magnetic bumpers add .312
 For S option add .187

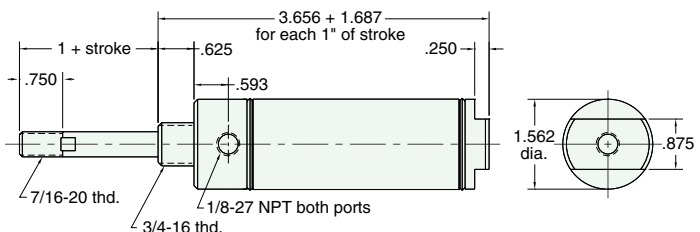



1 1/2" BORE STAINLESS STEEL CYLINDER

SFR-24-□-□

Double Acting, Front Spring Bias

Mount: Stud **Standard Stroke Lengths:** 1/2, 1, 1-1/2, 2, 3, 4
Type: Rotating Rod **Spring Compressed:** 10 lbs. **Spring At Rest:** 4 1/2 lbs.
Options: MB, B, H, W, V, P6, P7, P8, S, N For magnetic bumpers add .312

For S option add .187

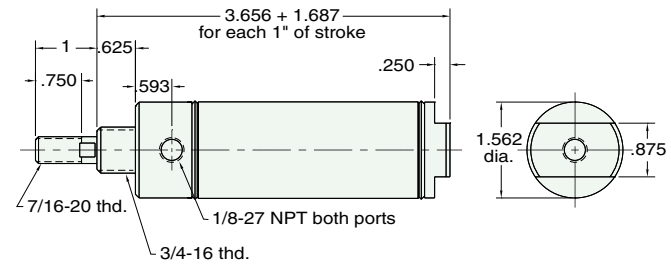

Pneumatic Stapler

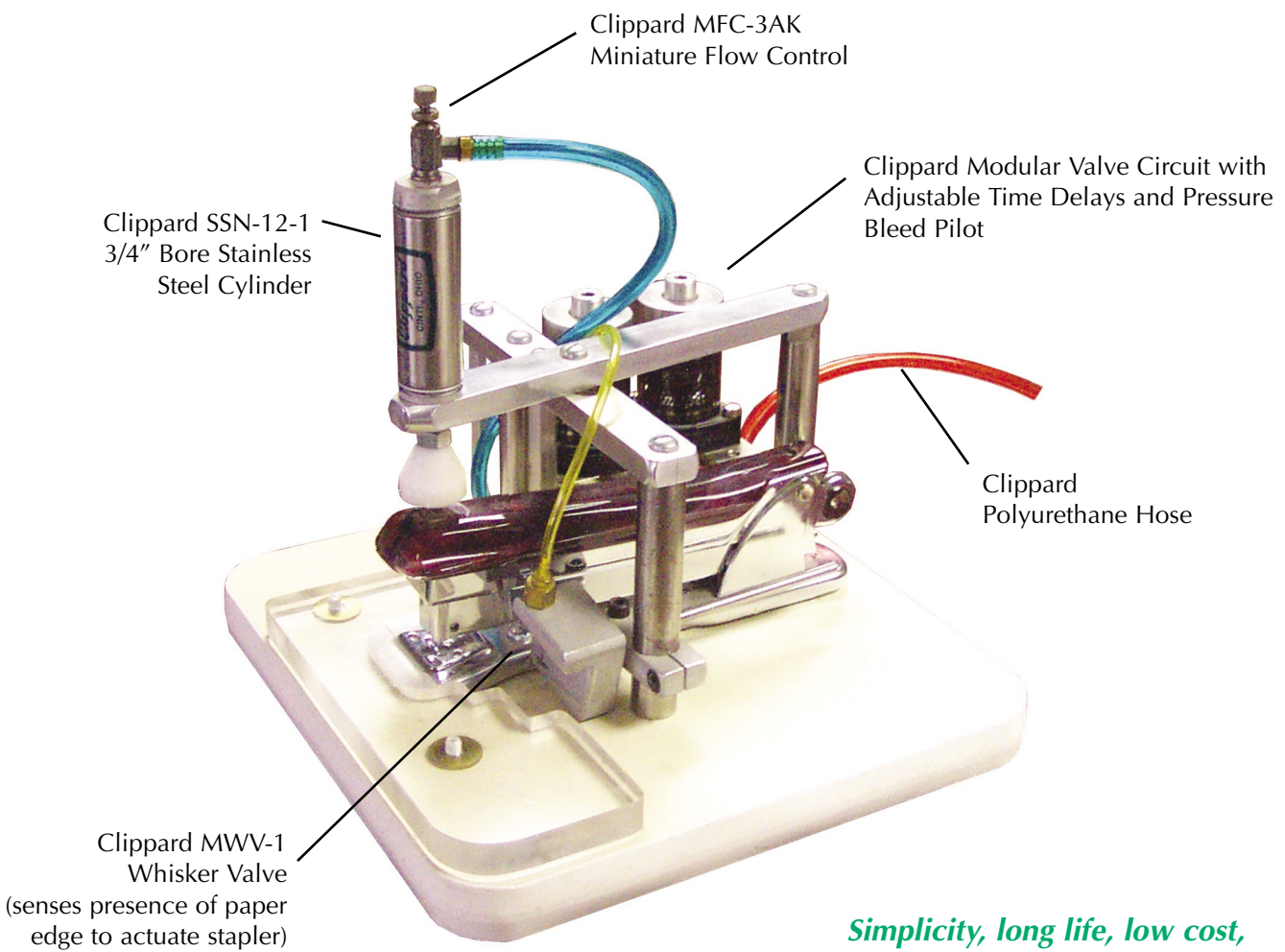

Simplicity, long life, low cost, ease of maintenance and high power are combined in this unique office stapler application.



MOUNTING NUTS

Stud Nut

Part Number	Across Flats	Nut Thickness	Nut (Thread)
N12-16	1 3/32	27/64	3/4-16

Rod Nut

Part Number	Across Flats	Nut Thickness	Nut (Thread)
N07-20	11/16	1/4	7/16-20

CB-2495

Clevis Bracket
Material: steel, bright zinc plated

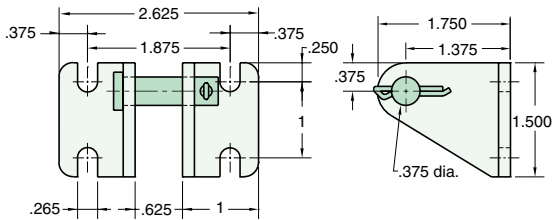

RC-2481

Rod Clevis
Material: steel, bright zinc plated

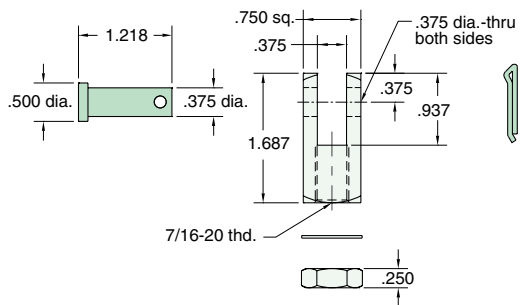

RE-2485

Rod End
Material: steel, bright zinc plated body

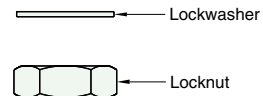
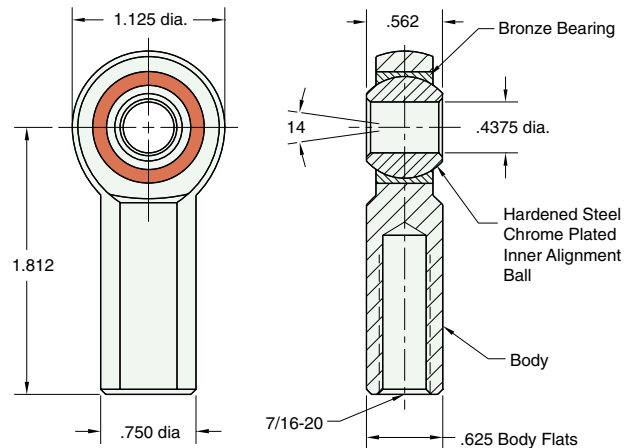

Max. Static Radial Load: 4300 lbs.
Fits Rod Thread Size: 7/16-24

FB-2491

Foot Bracket
Material: steel, bright zinc plated

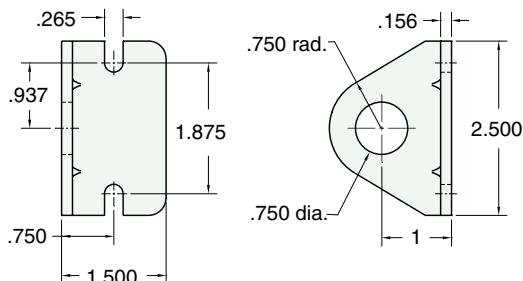



1 3/4" BORE STAINLESS STEEL CYLINDER

SSN-28-□-□

Single Acting



Mount: Stud **Standard Stroke Lengths:** 1/2, 1, 1-1/2, 2, 3, 4
Type: Non-Rotating Rod **Spring Compressed:** 24 lbs. **Spring At Rest:** 11 lbs.
Options: MB, V, S, N **Bumpers are standard** For magnetic bumpers add .312

For S option add .562

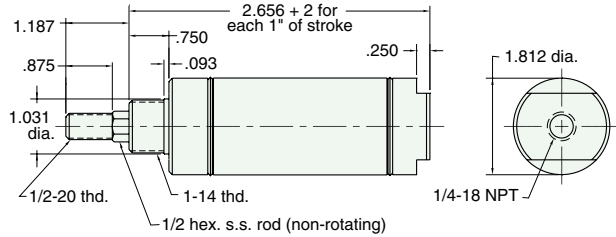

SSR-28-□-□

Single Acting



Mount: Stud **Standard Stroke Lengths:** 1/2, 1, 1-1/2, 2, 3, 4
Type: Rotating Rod **Spring Compressed:** 24 lbs. **Spring At Rest:** 11 lbs.
Options: MB, V, S, N **Bumpers are standard** For magnetic bumpers add .312

For S option add .562

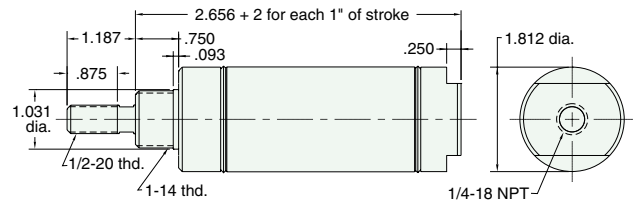

USN-28-□-□

Single Acting



Mount: Universal **Standard Stroke Lengths:** 1/2, 1, 1-1/2, 2, 3, 4 Furnished without nut(s) See chart on page 51
Type: Non-Rotating Rod **Spring Compressed:** 24 lbs. **Spring At Rest:** 11 lbs.
Options: MB, V, P2, P3, P4, P5, P6, P7, P8, N **Bumpers are standard** For magnetic bumpers add .312

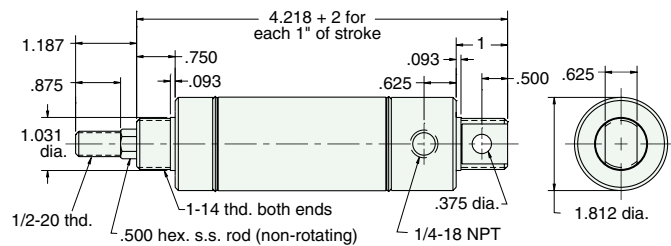

USR-28-□-□

Single Acting



Mount: Universal **Standard Stroke Lengths:** 1/2, 1, 1-1/2, 2, 3, 4 Furnished without nut(s) See chart on page 51
Type: Rotating Rod **Spring Compressed:** 24 lbs. **Spring At Rest:** 11 lbs.
Options: MB, V, P2, P3, P4, P5, P6, P7, P8, N **Bumpers are standard** For magnetic bumpers add .312

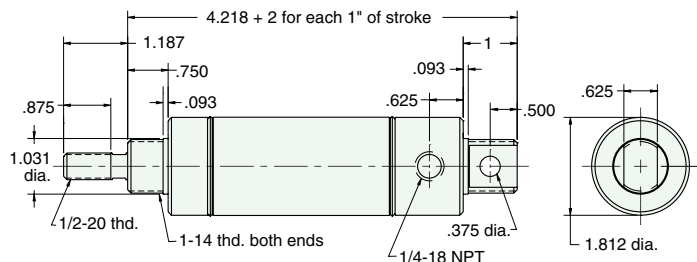

1 3/4" BORE STAINLESS STEEL CYLINDER



SDR-28-□-□

Double Acting



Mount: Stud **Standard Stroke Lengths:** 1/2, 1, 1-1/2, 2, 3, 4, 5, 6

Type: Rotating Rod

Options: C, F, R, MB, W, V, P6, P7, P8, S, N

Bumpers are standard

For magnetic bumpers add .312

For C, F, R and S option add .562

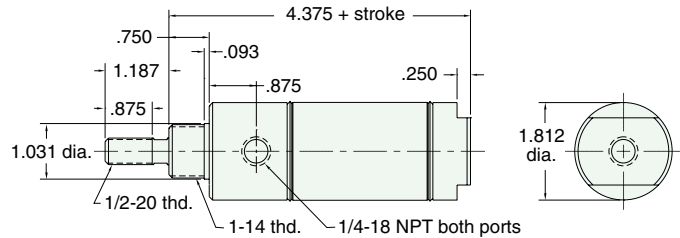

For C, F, & R options use side ported rear head

UDR-28-□-□

Double Acting



Mount: Universal **Standard Stroke Lengths:** 1/2, 1, 1-1/2, 2, 3, 4, 6, 8, 10, 12

Type: Rotating Rod

Options: C, F, R, MB, W, V, P2, P3, P4, P5, P6, P7, P8, N

Bumpers are standard

For magnetic bumpers add .312

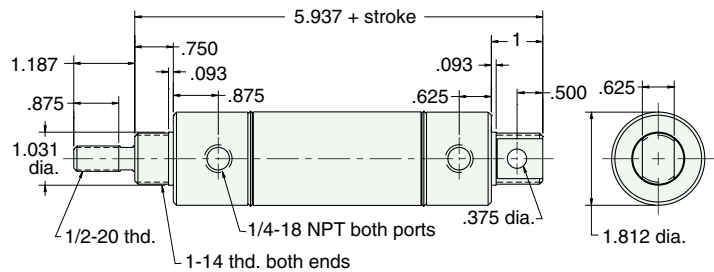

SDD-28-□-□

Double Acting



Mount: Stud **Standard Stroke Lengths:** 1, 2, 3, 4, 5, 6, 8, 10, 12

Type: Double Rod

Options: C, F, MB, W, V, P6, P7, P8, N

Bumpers are standard

For magnetic bumpers add .312

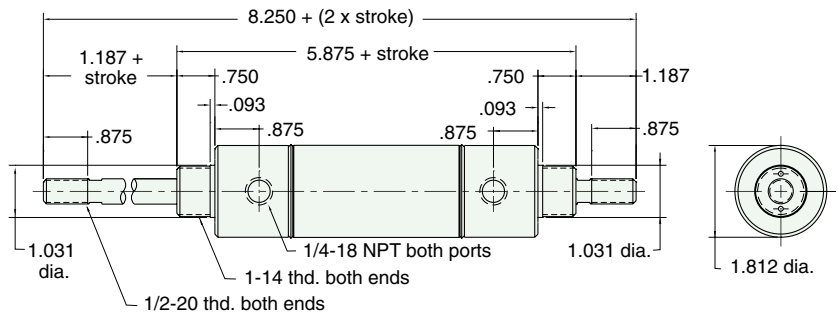

SRR-28-□-□

Reverse Acting



Mount: Stud **Standard Stroke Lengths:** 1/2, 1, 1-1/2, 2, 3, 4

Type: Rotating Rod

Options: MB, W, V, N

Spring Compressed: 24 lbs. **Spring At Rest:** 11 lbs.

Bumpers are standard

For magnetic bumpers add .312

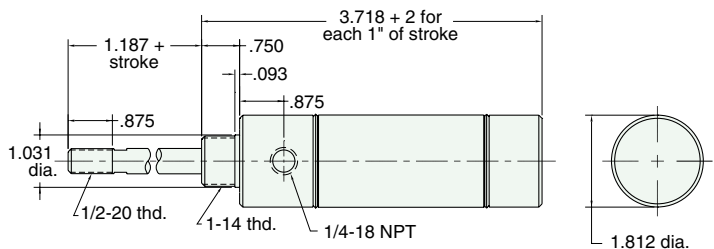



1 3/4" BORE STAINLESS STEEL CYLINDER

URR-28-□-□

Reverse Acting

Mount: Universal **Standard Stroke Lengths:** 1/2, 1, 1-1/2, 2, 3, 4
Type: Rotating Rod **Spring Compressed:** 24 lbs. **Spring At Rest:** 11 lbs.
Options: MB, W, V, P6, N **Bumpers are standard**

For magnetic bumpers add .312

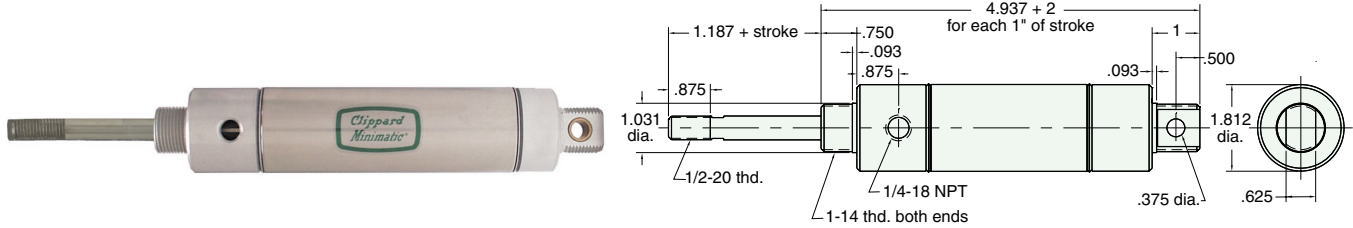

Dual Double Stacked Cylinder Press

